



We have a vast collection of masterpieces

CASE STUDY

Defining the Control Management Processes at DAMM

BPM and Budgeting Process



Industry

Food & Beverages

Application Area

Sales, Logistic, Finance and Budgeting

Company

Damm is a brewery located in Barcelona, producing, distributing and selling beer, juices and water.

With a 70% market share and a yearly turnover of € 700 million, Damm is the leader in the Northern-east of Spain.

Business Challenges

After going through a large SAP implementation, Damm started to rethink their IT strategy.

In order to set-up a correct strategy in terms of Control Management with a clear business goal, Damm has contracted SDG consulting to define and design the Control Management Processes and to re-organize the information flow, solving the following issues:

- Definition of the BPM with a TOP-DOWN approach
- Definition of the main "corporate reporting" for the steering committee
- Definition of the budgeting processes by business and by channel, from the business plan defined by the General Manager to the detailed budgeting process
- Validation of the software selection in order to implement the conceptual business model

BOARD Solution

The most important goal of the project was the definition of the control management processes, with three different work-streams:

- Strategic Map definition
- KPIs and reporting to control and manage the business
- Budgeting and plan definition



We have a vast collection of masterpieces

CASE STUDY

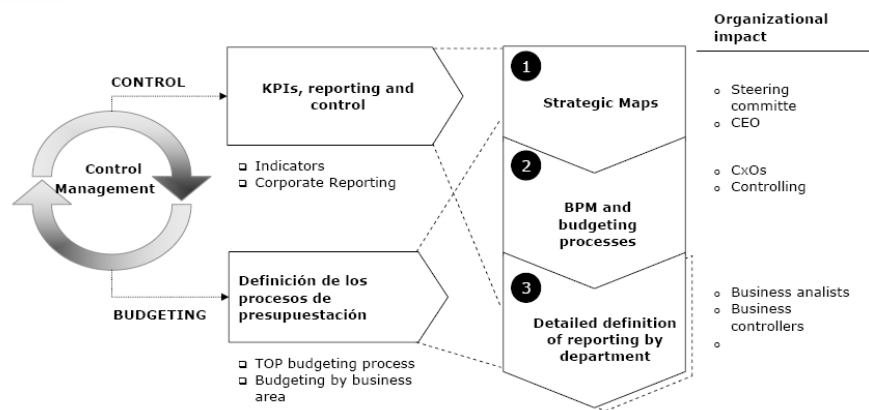

The unique Toolkit approach adopted by BOARD means that BOARD is a unified platform where BI and CPM features are available together to deliver customized solutions. In BOARD scorecards, strategy maps, initiative management are easily and quickly built with standard core features and not, as in other products, with layered add-ons.

The figure below, for example, illustrates the breadth of the CPM implementation made with BOARD at Damm:

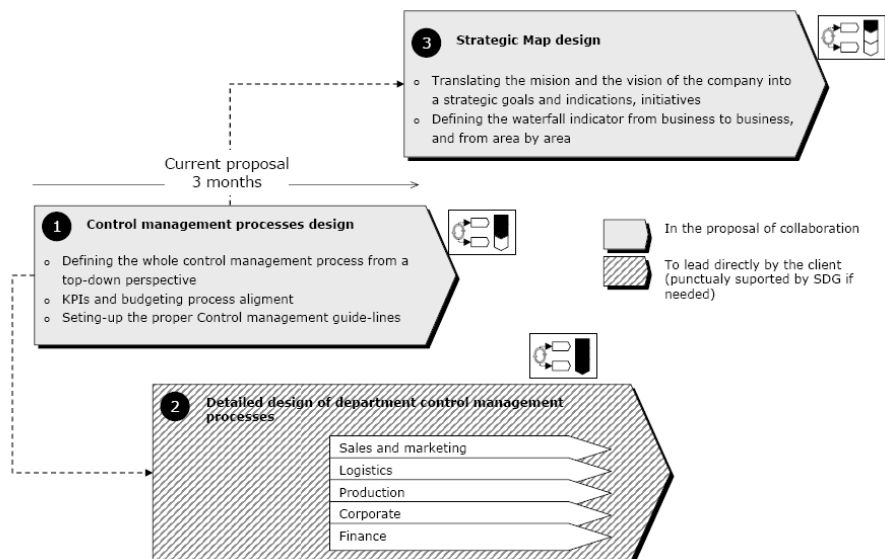

The power of BOARD's dual engine (ROLAP and MOLAP) allows building very complex models, with large volumes of data. BOARD's multi-cube structure means that we can easily link in a model heterogeneous data sources and



We have a vast collection of masterpieces

CASE STUDY

define sophisticated processing logics.

Functions like:

- Support for all activity-based costing methodologies, including bottom-up, consumption-driven ABC
- Unlimited scenarios, activities, cost drivers and cost objects to build even the most complex models
- Make or Buy models
- Cost allocation at any level, multi-allocation rules
- Impact analysis (e.g. impact of a raw material cost variance on Customer's profitability)
- EVA, ROI and Free Cash-flow analysis

and much more become achievable with BOARD Toolkit standard features.